

WHAT'S INCLUDED

Each Mini LOOP BT Controller includes:

| Item | Description | Quantity |
|------|----------------------------------|----------|
| A | LOOP Mini Controller w/Bluetooth | 1 |
| B | Temperature Sensor | 1 |
| C | 3M Adhesive | 1 |
| D | Mounting Bracket | 1 |
| E | Wood Screws | 2 |

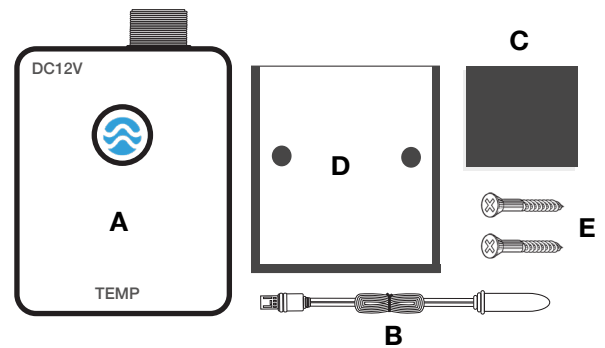

IMPORTANT: If you are missing any components, do not contact your retailer. Please contact us at: www.current-usa.com/warranty



IMPORTANT - BEFORE INSTALLATION

- Unplug all power to any existing LOOP products.
- DO NOT expose controller to moisture, water or salt creep.
- DO NOT use with LOOP IR Controller or Remote (they are not compatible)

When connecting LOOP products to controller, gently slide connector in and tighten. Do not twist or rotate. Excessive force can damage pin connections.

MOUNTING INSTRUCTIONS

1. Remove controller and all components from packaging.
2. Locate a mounting position for controller, ensuring it is in a dry place away from water splashing, salt creep or dripping water.
3. Clean mounting location of any dirt or debris using a damp rag.
4. Attach Controller mount to cabinet using either 2 wood screws or 3M Adhesive (included).

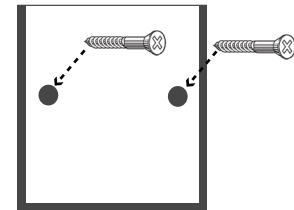

CABLE CONNECTIONS

1. Connect LED light to Mini BT controller by gently pushing into top 3-pin connector and tightening.
2. Place temperature sensor into sump or aquarium and attach using suction cup.
3. Connect Temperature sensor to Temperature USB port on bottom of controller.
4. Attach controller to cabinet by sliding vertically into mounting bracket.

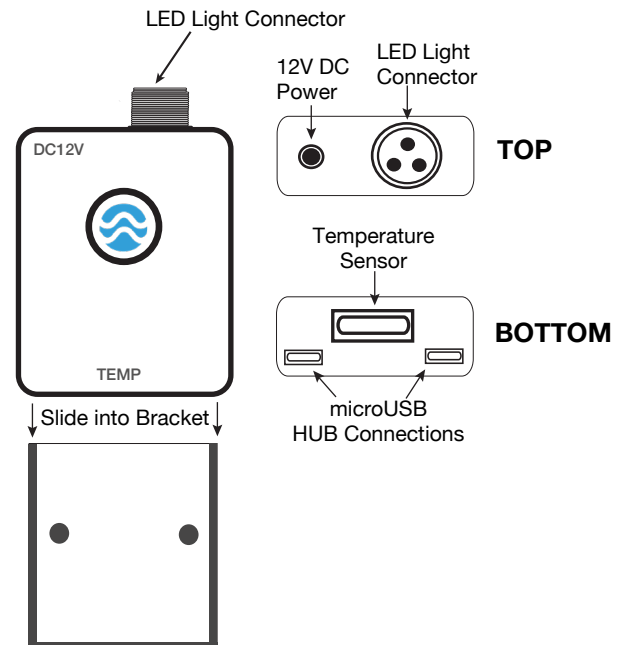

CABLE CONNECTIONS

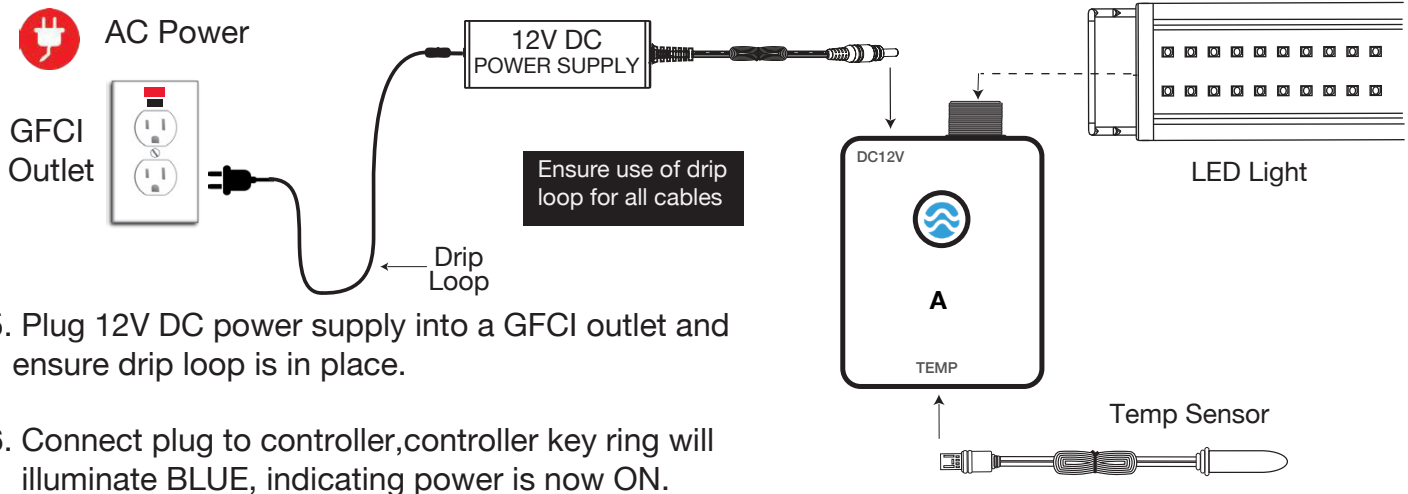

5. Plug 12V DC power supply into a GFCI outlet and ensure drip loop is in place.
6. Connect plug to controller, controller key ring will illuminate BLUE, indicating power is now ON.

CONTROLLER OPERATION AND FEATURES

Controller Key Ring displays status of controller. There are 4 indicators/features using the Key Ring:

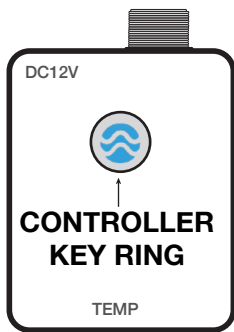

- BLUE** - Indicates normal operation. Press once to activate feed mode.
- PURPLE** - Indicates controller is in manual feed mode (will resume after 10 min.)
- WHITE** - Indicates controller is in manual ON (Daylight setting) mode. Press Key for 3 seconds, LED light will turn ON to Daylight setting. Press a again for 3 seconds to resume app settings (Bluetooth.)
- GREEN** - LOCK feature, locks the controller settings and prevents other mobile devices from connecting to controller. Press and hold Key for 6 sec. to lock settings. Press and hold for 6 sec. to unlock.
- RED** - Voltage issue. Ensure ONLY 12VDC power is connected.

Product Specifications

| | |
|-------------------|-----------------------------|
| Model: | 1695 |
| LED Light Input: | 12VDC, 60w max per channel |
| Temperature Port: | USB, (+/- 1° C) |
| MicroUSB Port(s): | 2 LOOP Networking |
| Communication: | Bluetooth 4.0 |
| Settings Memory: | Flash |
| Battery Backup: | Built-in |
| Operating Temp: | (0° - 45°C) |
| Dimensions: | 1.75 in. x 3 in. x 0.75 in. |
| Weight: | 2 oz. |

Mobile Device/App Requirements:

Bluetooth 4.0 Compatible
 iPhone 4S or above running iOS 9 or above.
 Android OS 4.0.3 or above

Contains transmitter module
 FCC ID: 2ABN2-RFBMS01



MOBILE DEVICE CONNECTION



IMPORTANT! The LOOP APP does NOT require a PIN code for Bluetooth connection. Please use the connecting instructions below.

1. Download the latest version of LOOP app:

www.current-usa.com/app



2. From your phone's Settings screen, search for Bluetooth and make sure it is turned on by moving the slider button to the right (please do not try to connect LOOP through this setting*.)

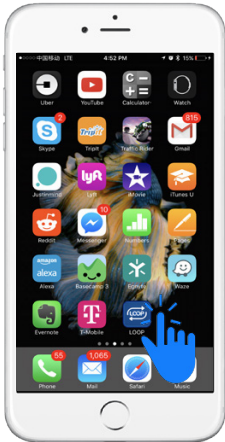

3. Open the LOOP App.

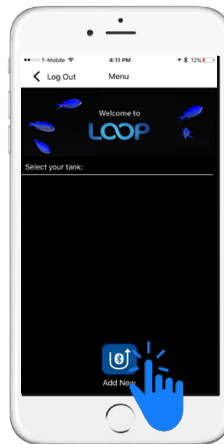

4. Press Add Device.

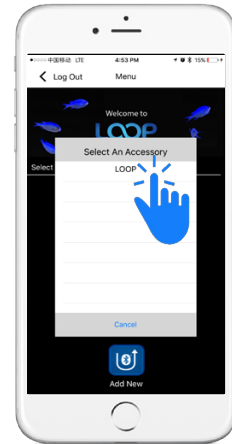

5. Select LOOP

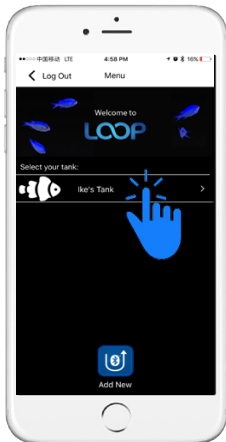

6. Select LOOP

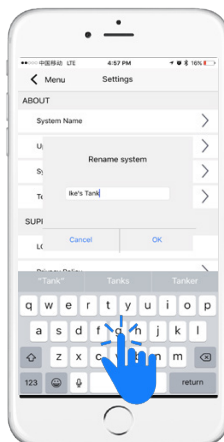

7. Rename system



8. Back to HOME

The *LOOP app does NOT require a PIN code or use the built-in Bluetooth pairing in your mobile device - the app itself will connect with your device using its own software.

Set up is complete, you're ready to experience LOOP!

For additional detailed instructions for setting up your LOOP system and troubleshooting tips, please visit our website support page at: www.current-usa.com/app

CONNECTING TO OTHER LOOP HUB MANIFOLDS

Use the below diagram as a guideline for connecting Add-On accessory items to your LOOP system. (HUB order can be re-arranged and only require connection to Bluetooth controller for app operation.)

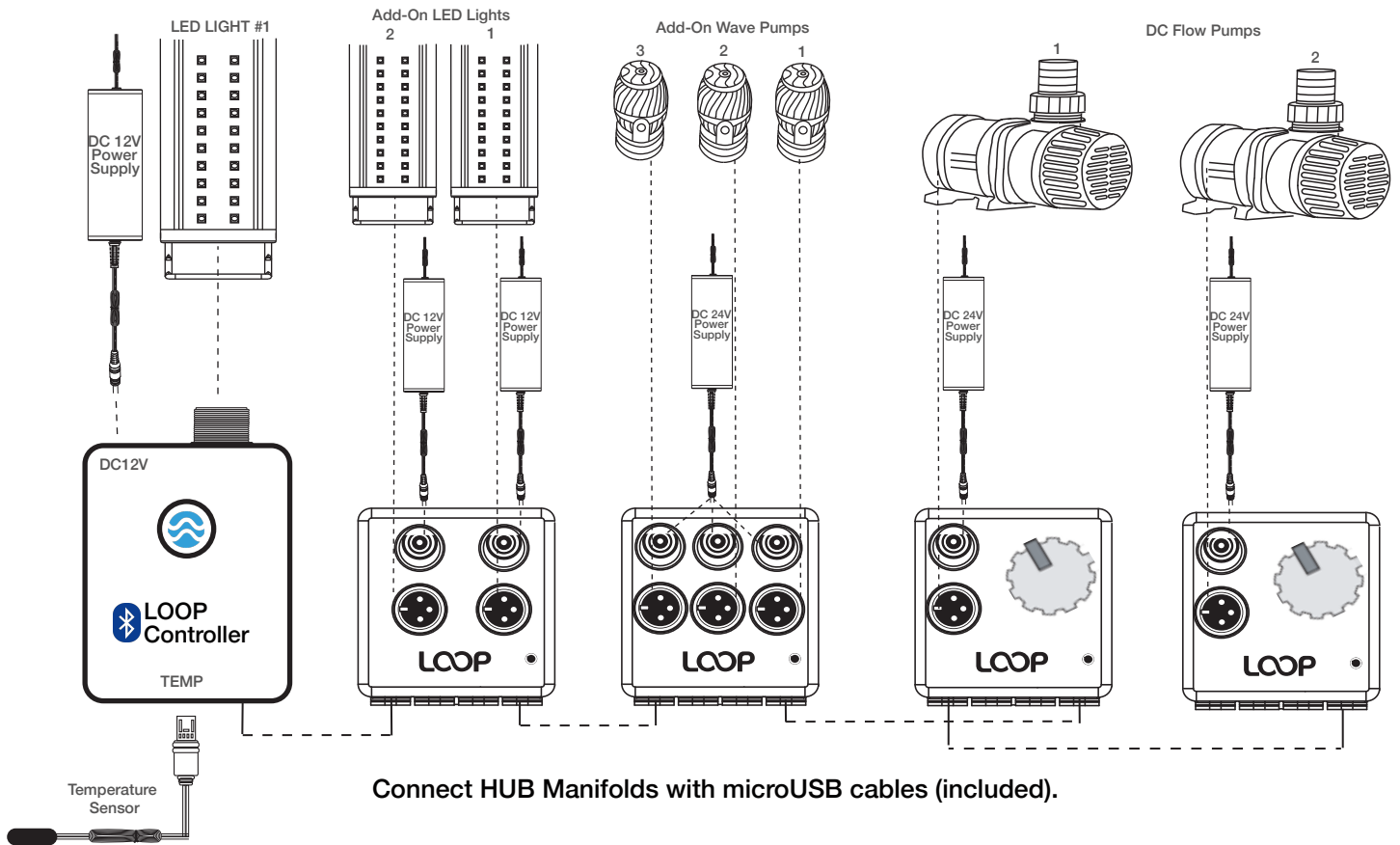

LIMITED WARRANTY

This product must be purchased from an authorized Current-USA reseller or directly from Current-USA, Inc. Visit our website for a list of authorized resellers. Current-USA, Inc. warrants this product against defects in materials and workmanship for ONE (1) YEAR from the date of original retail purchase and is non-transferable.

Warranty on all products is limited to replacement of the product and does NOT cover fish loss, personal injury, property loss or direct, incidental or consequential damage arising from the use of this product. NOTE: Current-USA, Inc. One-Year Limited Warranty does not cover damage caused by the following: improper installation, saltwater corrosion, electrical surges or modifications.

THE WARRANTY AND REMEDIES SET FORTH ABOVE ARE EXCLUSIVE AND IN LIEU OF ALL OTHERS, WHETHER ORAL OR WRITTEN, EXPRESSED OR IMPLIED. CURRENT USA INC. SPECIFICALLY DISCLAIMS ANY AND ALL IMPLIED WARRANTIES INCLUDING BUT NOT LIMITED TO LOST PROFITS, DOWNTIME, GOODWILL, DAMAGE OR REPLACEMENT OF EQUIPMENT AND PROPERTY, AND ANY COSTS OF RECOVERING ANIMALS, PLANTS, CORALS, TANKS OR OTHER AQUARIUM RELATED ITEMS AND/OR EQUIPMENT. CURRENT USA, INC. IS NOT RESPONSIBLE FOR SPECIAL, INCIDENTAL OR CONSEQUENTIAL DAMAGES RESULTING FROM ANY BREACH OF WARRANTY, OR ANY COSTS OF RECOVERING OR REPRODUCING ANY EQUIPMENT, ANIMALS OR PLANTS USED OR GROWN WITH CURRENT-USA, INC. PRODUCTS. Some jurisdictions do not allow the exclusion or limited of incidental or consequential damages or exclusions of implied warranties, so the above limitations or exclusions may not apply to you. This warranty gives you specific legal rights, and you may also have other rights that vary from jurisdiction to jurisdiction.